



Cloncurry

Shire Council

Landscape Concept

Scarr Street, Cloncurry

Project Reference: L24014

Designed: SS / EP

Gold Coast

1638 Tweed Street, Burleigh Heads QLD 4220

PO Box 3805, Burleigh Town QLD 4220

Gladstone

2/172 Goondoon Street, Gladstone, QLD 4680

PO Box 5332, Gladstone QLD 4680

admin@zonelandscape.com.au

Document Control

Document Revisions

Rev.	Comments	Date	Initial
A	Draft Issue	15/04/24	SS/EP
B	For Review	16/04/24	SS/EP
C	For Review	17/04/24	SS/EP
D	Milestone 02	24/05/24	SS/EP

Document Sources

Rev.	Base Information	Issued By	Issued
A	Civil PDF.pdf	Align Engineering	13/05/24
A	23683-CD-01	Vision Survey Queensland	06/09/23
B	WEBB_DESIGN_XREF_ELECTRICAL.dwg	Webb Australia Group PTY LTD	24/04/24
B	PTG/00093 S00-001.pdf	PTG Consulting	24/05/24

Contents

1.0	Site Context	4	2.0	Concept Design (cont.)	
11	Location	5	2.6	Streetscape Section 02	21
12	Existing Landscape	6	2.7	Planting Palette	22
13	Existing Embellishments	8	2.8	Hardstand Plan	24
14	Existing Character	10	2.9	Hardstand Palette	26
15	Proposed Character	11	2.10	Network & Wayfinding Strategy	28
			2.11	Signage Plan	30
			2.12	Embellishments Plan	32
2.0	Concept Design	12	2.13	Embellishments	34
2.1	Overall Plan	13	2.14	Signage/Sculptures	35
2.2	Landscape Plan	14	2.15	Embellishments Options	36
2.3	Shade & Canopy Plan	16	2.16	Embellishments Materials	38
2.4	Services Plan	18	2.17	Lighting Plan	40
2.5	Streetscape Section 01	20			

1.0 Site Context.



1.2 Existing Landscape

Site Context



Site Context

1.2 Existing Landscape

- 1 Scarr & Sheaffe Street Intersection**
 Median & kerb planting at the Scarr & Sheaffe St Round-A-Bout. Planting is sparse with mix of low groundcovers including Boat Lilly, Dianella species and Desert Roses, red cypress mulch to base, potential to use this treatment in upgrade works.
- 2 Scarr Street Central Median**
 Central median planting beds at irregular intervals/sizes along Scarr St. One to two trees are planted per garden bed, with species including Weeping Bottlebrush, Yellow Poinciana, Spotted Gums and Pudding Pipe Trees. A single garden bed contains a perimeter of Syzygium 'Tiny Trev' to the base of a spotted gum.
- 3 Verge Turf**
 Turf to the public verges along Scarr Street. Species includes a mix of green and blue couch. The presence of crab grass and other broadleaved weeds are also present throughout.
- 4 Florence Clark Memorial Park**
 Public park adjacent the Cloncurry swimming pool. Park includes standard embellishments such as shelters, shade sails, BBQ's, bin enclosure's, benches, skate/play equipment etc, with a large open turf space centrally with direct access to the road reserve. Multiple large canopy shade trees border the BBQ area. Steel frame and wire arbors scattered throughout with climbing species to the base.
- 5 Raised Concrete Planters**
 Exposed aggregate concrete plater boxes at ~600mm high within the public verge adjacent the kerb. Planted with Desert Rose and Desert Star with re cypress mulch to the base.

1.3 Existing Embellishments

Site Context



Site Context

1.3 Existing Embellishments

- W Public Waste Bin Locations**
Public wheellie bin locations. Combination of post lock-style locations and formal lockable bin enclosures. Potential to replace with updated formal bin enclosures with recycling and landfill options.
- S Bench/Picnic Seating**
Public bench seating and picnic tables.
- M Memorial Signage**
War memorial statues, signage & information boards.
- P Information Plaques**
Cloncurry historical information plaques, mounted on metal plinth.
- Steel Signage**
Existing laser cut corten steel feature signage to remain.

1.4 Existing Character

Site Context



1.5 Proposed Character

Site Context

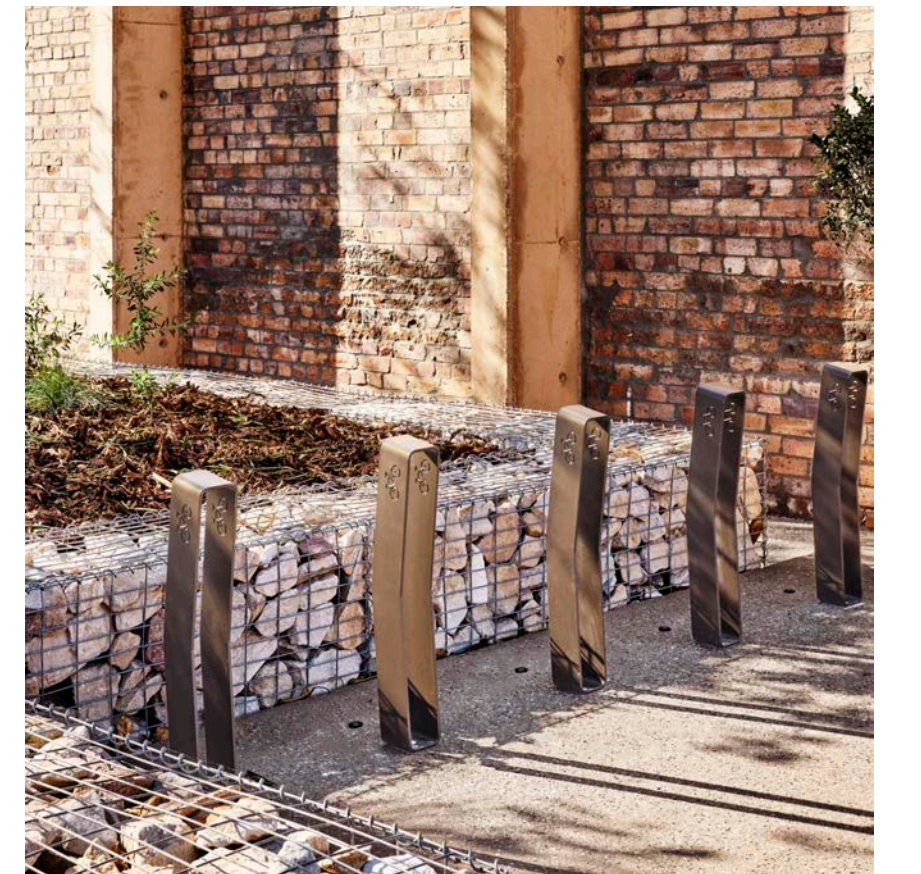
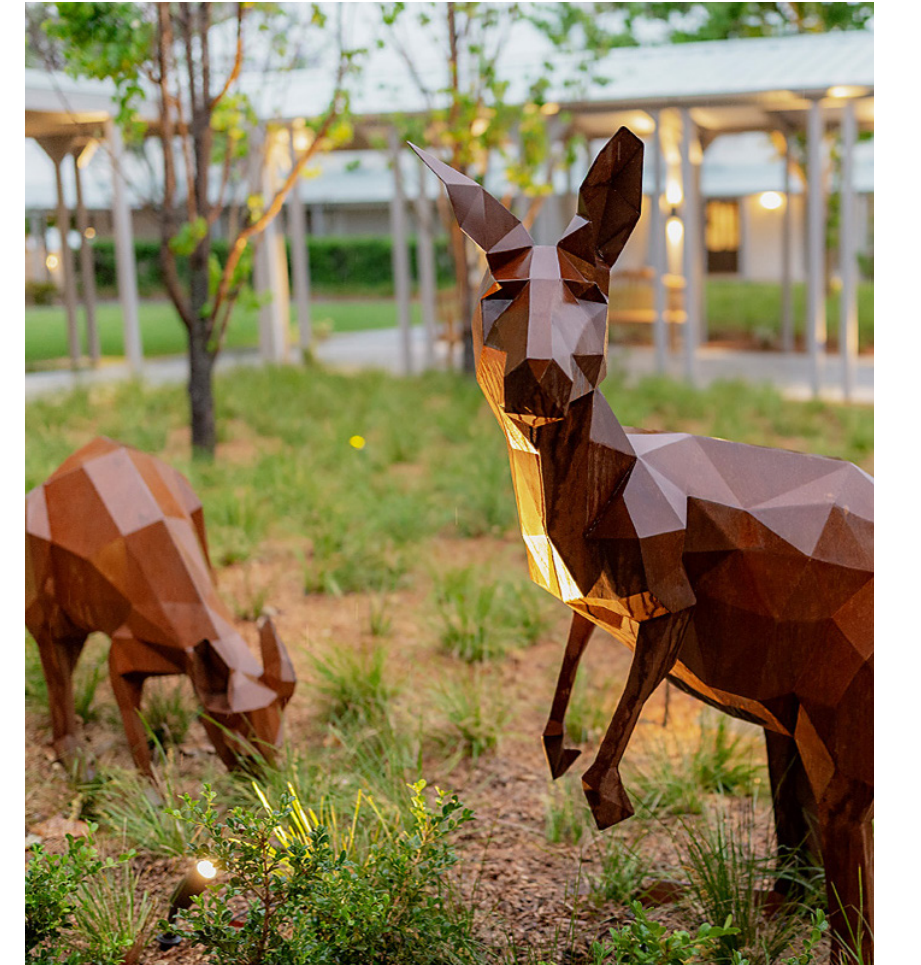

2.0 Concept Design.

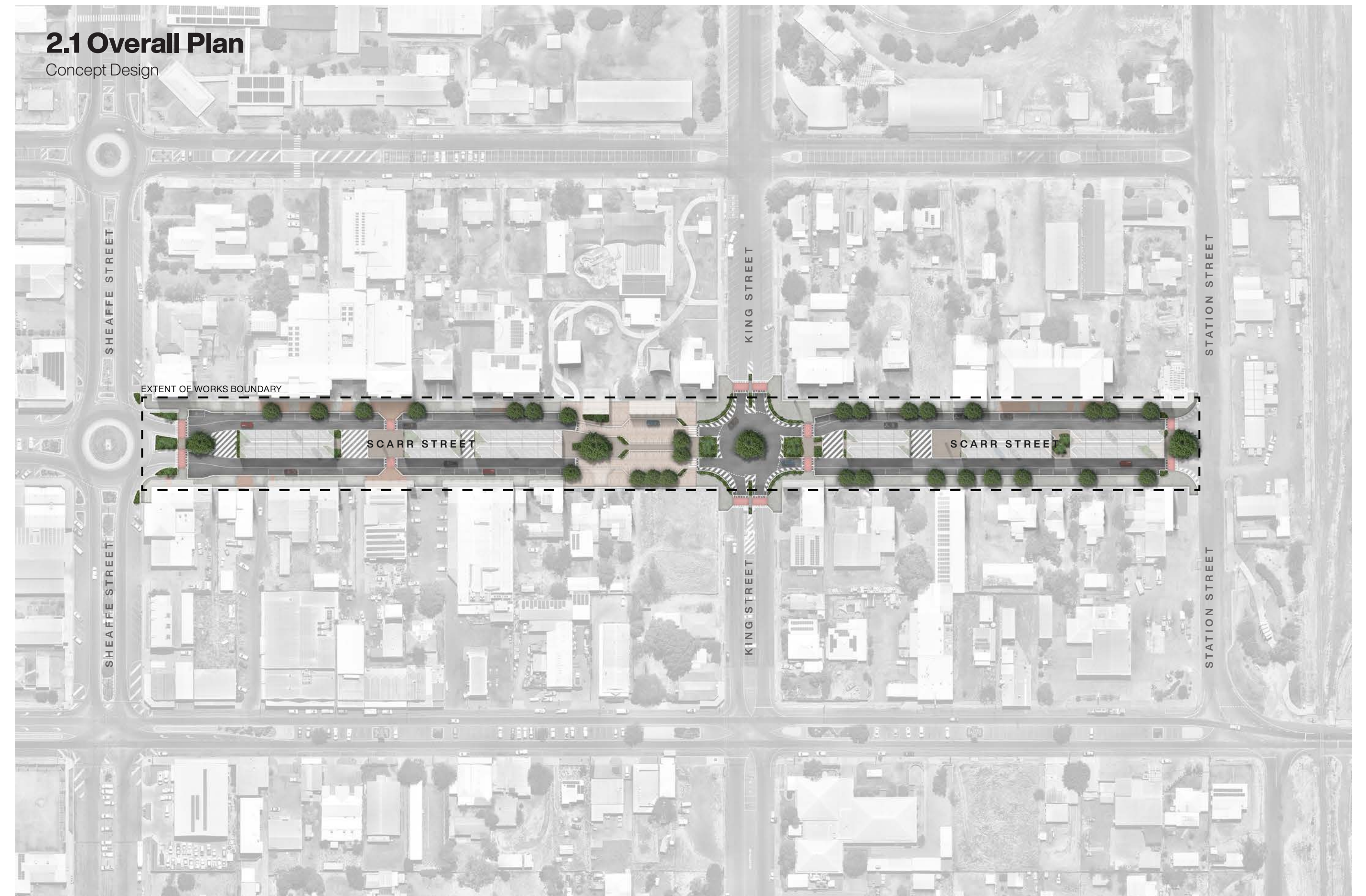

2.1 Overall Plan
Concept Design

2.2 Landscape Plan

Concept Design

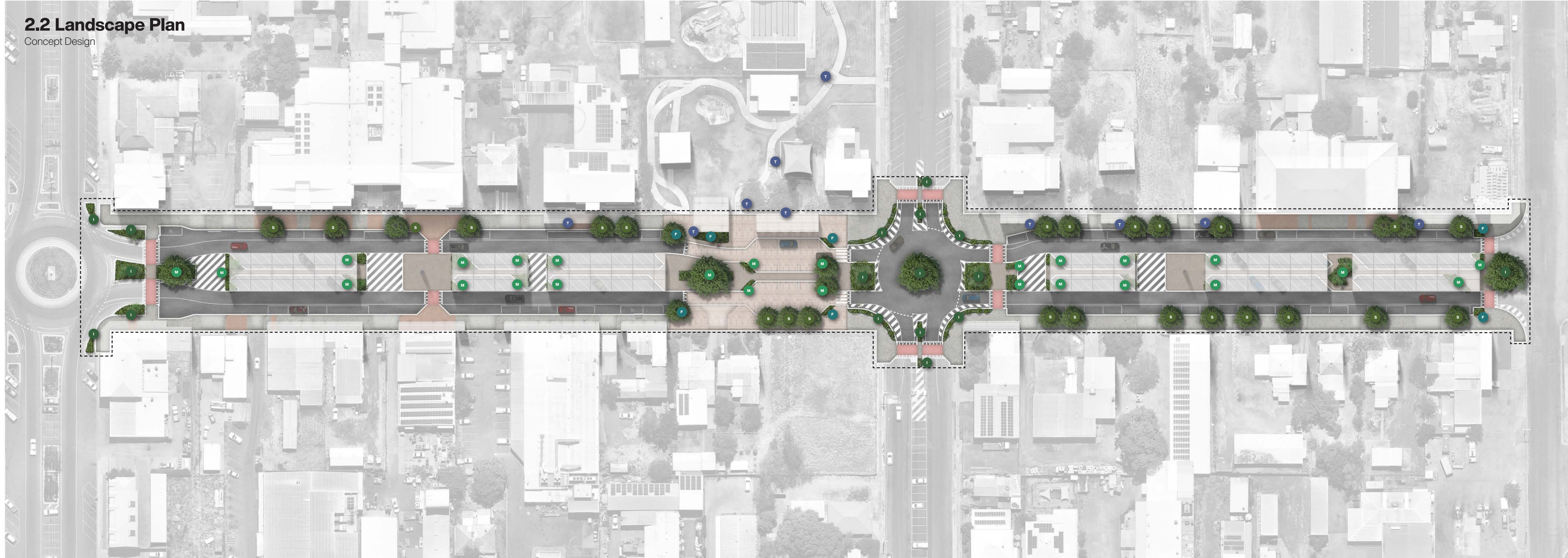

Concept Design

2.2 Landscape Plan

I Intersection Planting

Planting to garden beds immediately adjacent the intersections between Scarr St, Sheaffe St, King St and Station St to be predominantly low ground covers, with opportunities for medium height accents placed strategically to retain sight lines at corners for drivers on approach to pedestrian crossings. Large canopy tree planting to center of the round-a-bout as well as layered low height ground covers to maintain sight lines.

M Central Median Gardens

Feature beds within and bordering the central median down Scarr St. Where awnings/shade structures prevent tree planting, there is an opportunity to include larger accent species to provide some landscaping height as well as layered ground covers and shrubs to the base.

F Footpath Plantings

Garden beds along Scarr St footpath. Mix of low ground covers and medium height accent and shrub species throughout.

S Street Tree Planting

Street trees planted at 7m centers along Scarr St kerbside. Species selection to provide interlocking canopies to create an avenue style feel along the path network. Can be used to frame building entries where applicable. Base to be treated with tree grates or rubber mulch to protect tree roots. Will require structural soil cells below hardstands to provide appropriate volumes of soil to promote tree growth.

T Trellis Planting

Opportunity to bring in trellis wire between awning posts short/scattered intervals where awnings interface with street trees. Climbing species planted to the base in longer garden beds connecting street tree locations.

2.3 Canopy & Shade Plan

Concept Design

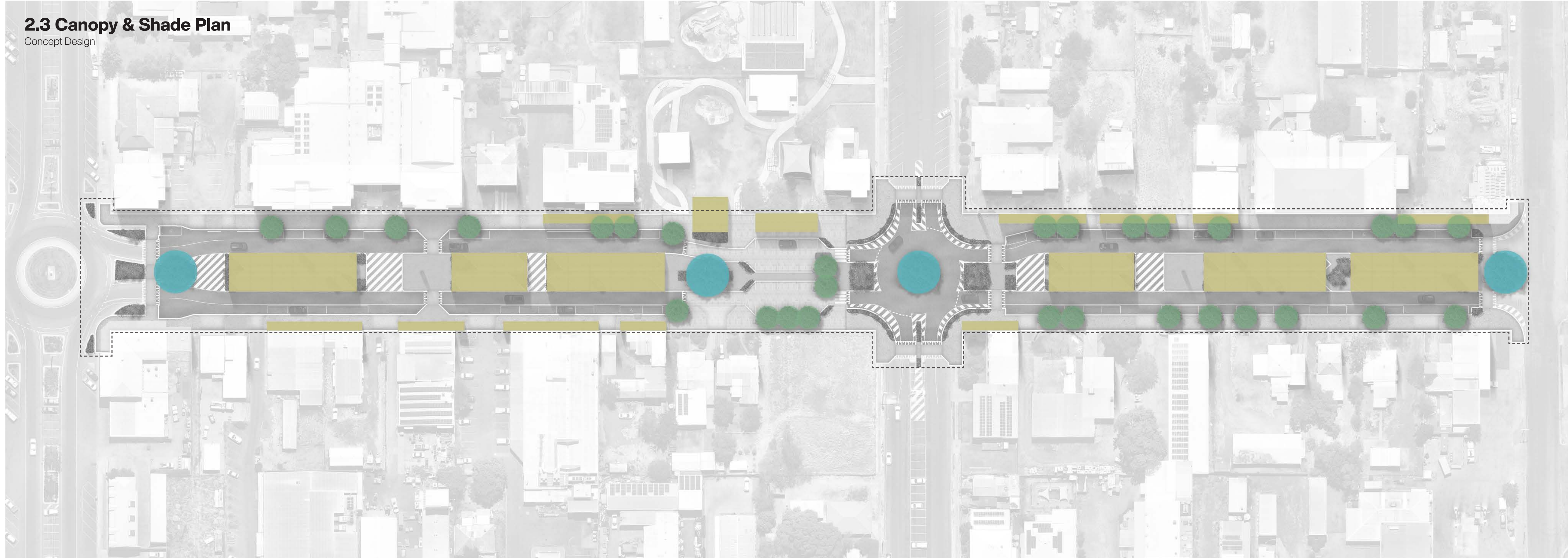

Concept Design

2.3 Canopy & Shade Plan

- **Street Tree Canopy**
Canopy shade provided by street trees at 7m centers at maturity. Species selection based on capability to interlock canopies and provide consistent shaded avenue.
- **Feature Tree Canopy**
Feature trees central to the round-a-bouts and central medians feature planting beds are to be a larger stock and species with potential for large canopy coverage where unhindered by building lines.
- **Awnings/Shelters**
Shade provided by a combination of existing structures, newly installed shelters and new awnings mounted from existing buildings. Design of shelters and awnings to be determined, shade is indicative only. Refer to structural options for further details.

2.4 Services Plan

Concept Design

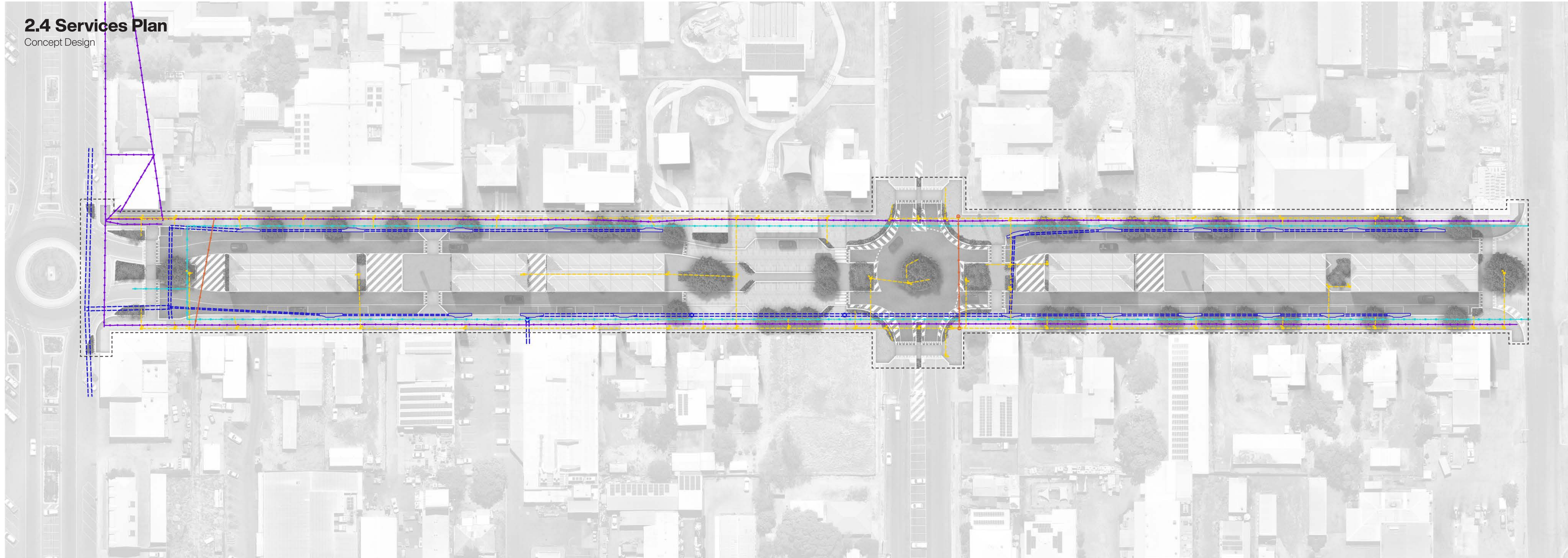

Concept Design

2.4 Services Plan

- **Telecom Conduits**
Telecommunications services alignment.
- **Electrical Conduits**
Electrical/Lighting services alignment.
- **Mains Water Line**
Mains Water services alignment.
- **Sewer Line**
Sewer/Waste services alignment.
- **Stormwater System**
Stormwater network alignment.

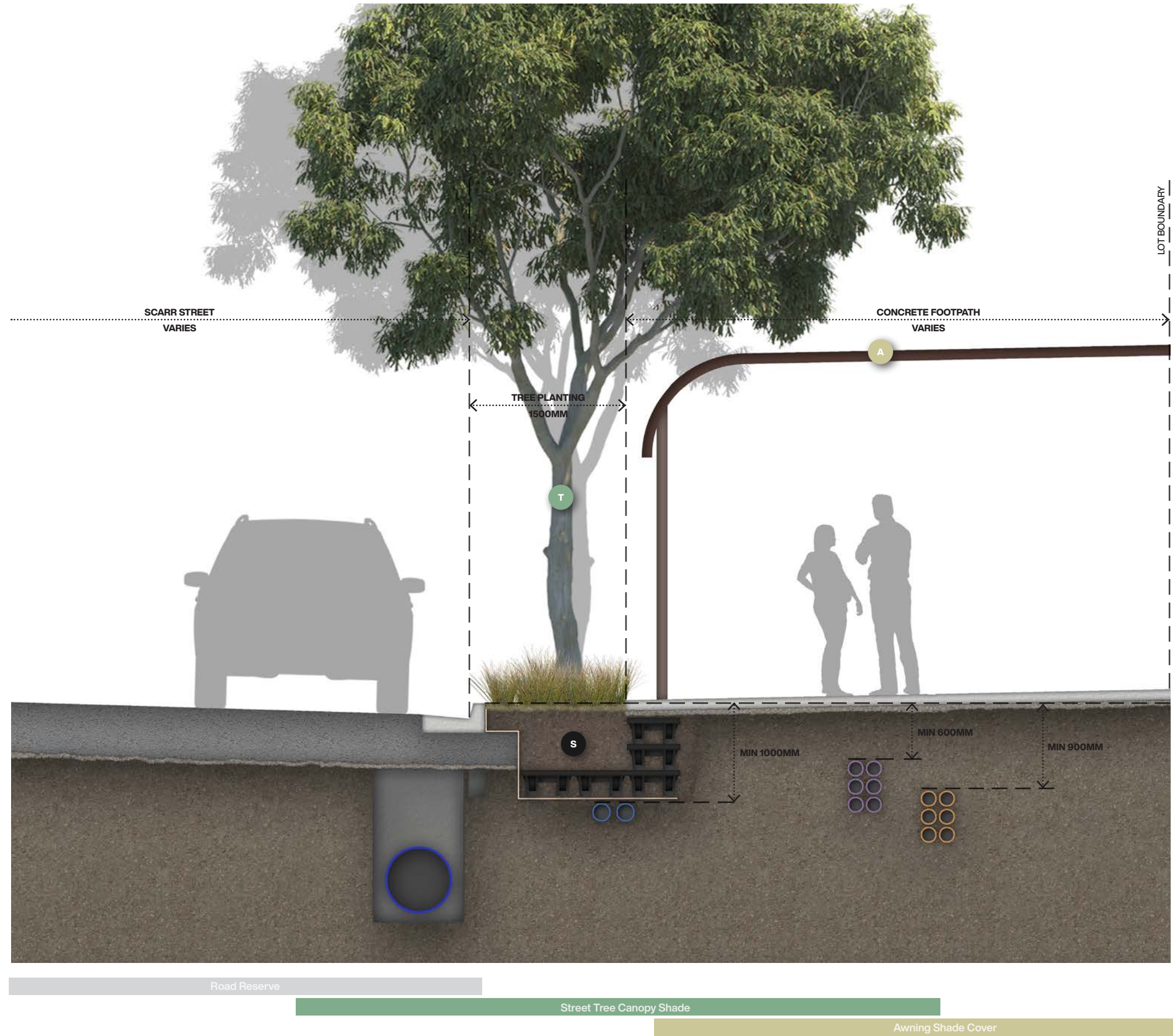

Concept Design

2.5 Streetscape Section 01

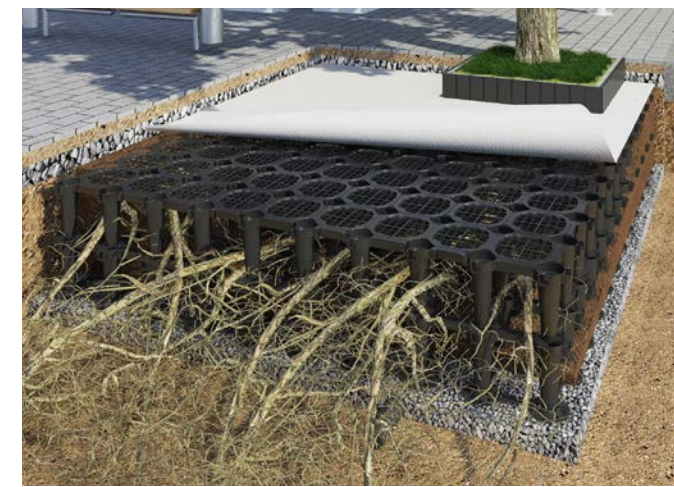
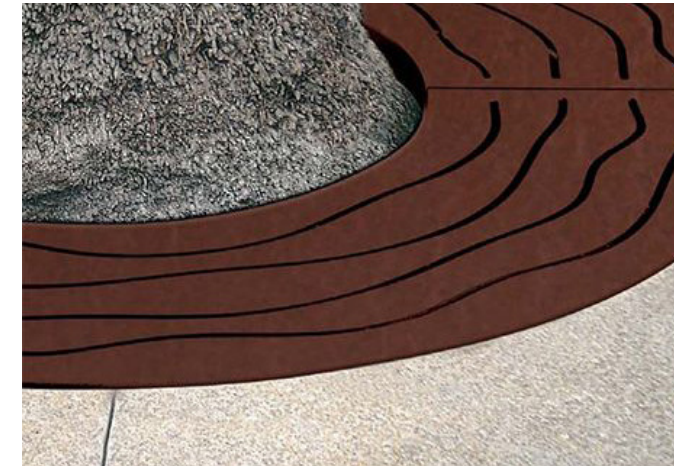

Concept Design

2.6 Streetscape Section 02

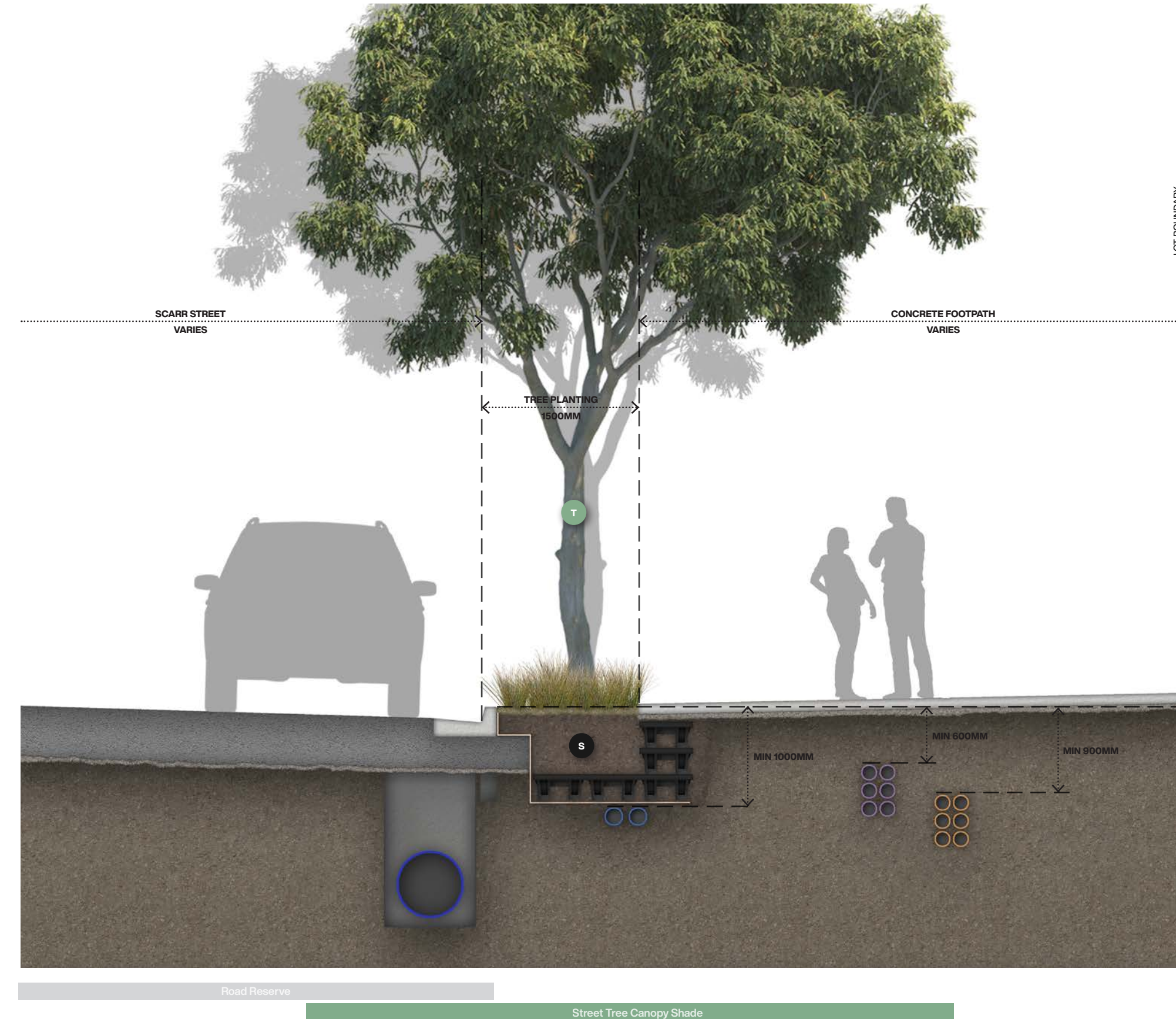

- **Telcom Conduits**
Telecommunications services alignment.
- **Electrical Conduits**
Electrical/Lighting services alignment.
- **Mains Water Line**
Mains Water services alignment.
- **Stormwater System**
Stormwater network alignment.
- T **Street Tree Canopy**
Canopy shade provided by street trees at 7m centers at maturity. Species selection based on capability to interlock canopies and provide consistent shaded avenue.
- A **Awnings/Shelters**
Shade provided by a combination of existing structures, newly installed shelters and new awnings mounted from existing buildings. Design of shelters and awnings to be determined, shade is indicative only. Refer to structural options for further details.
- S **Structural Soil Cell**
Structural Soil Cell to street tree surrounds to ensure optimum soil volume/reduce compaction. Root barrier provided to road/services interfaces where required. All offsets from trees to be confirmed through coordinated design.

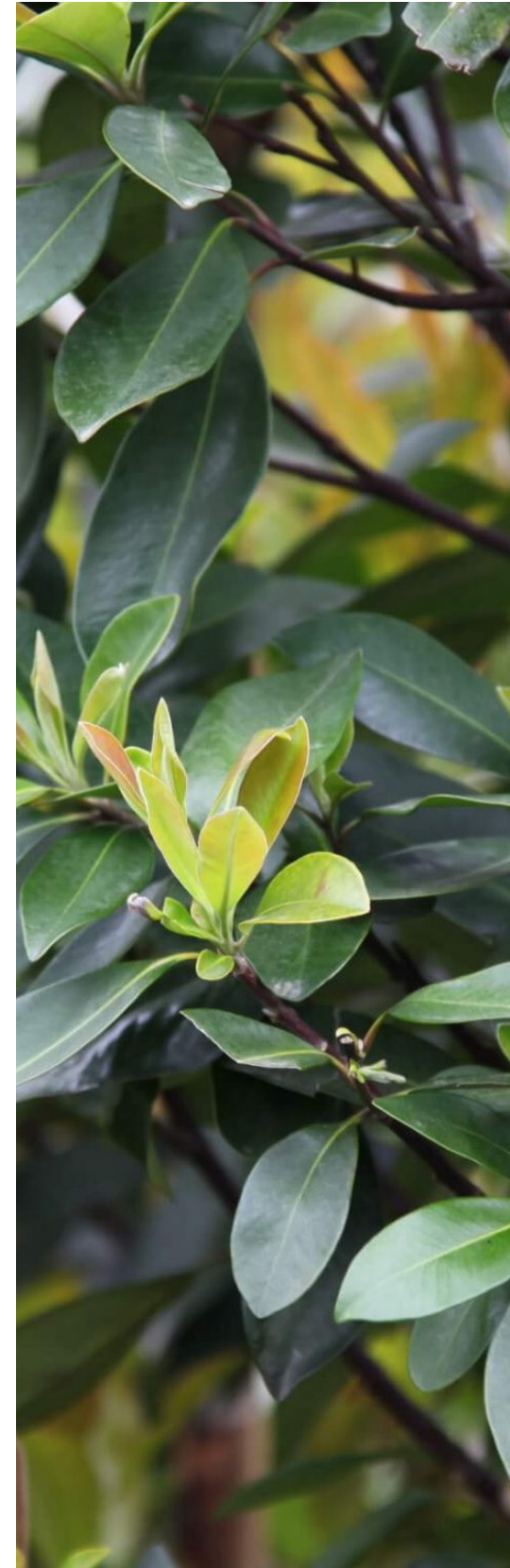

Tristaniopsis luscious
Luscious



Melaleuca quinquenervia
Broad-leaved paperbark



Buckinghamia celcissima
Ivory Curl

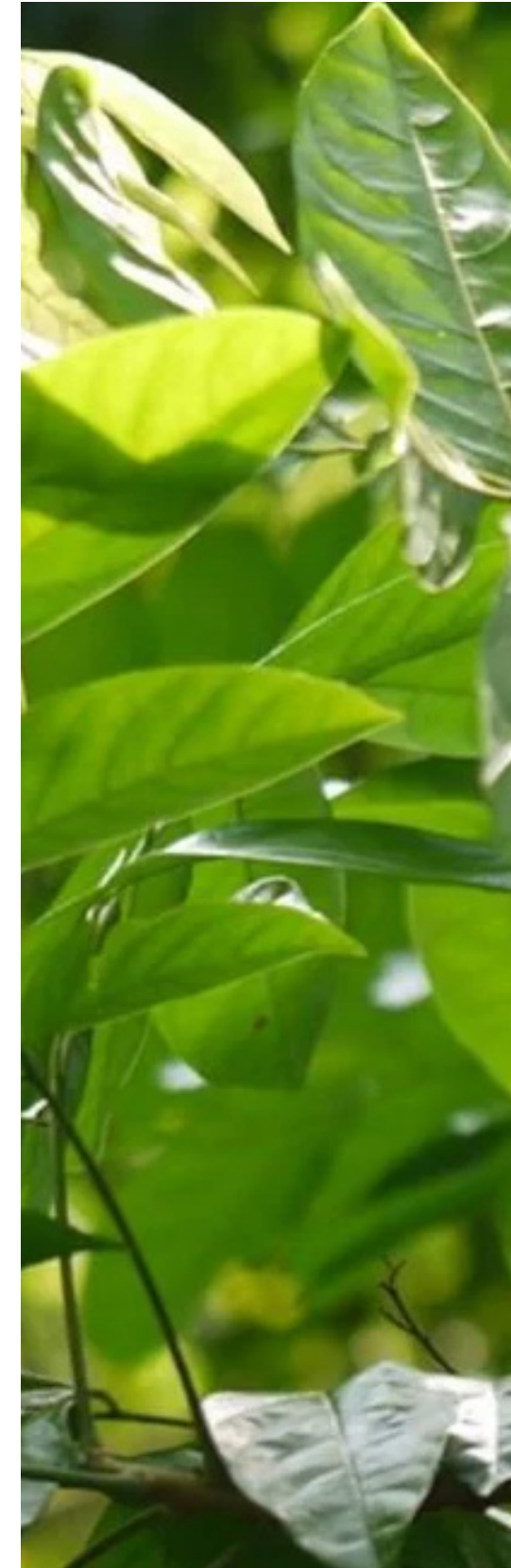

Harpullia pendula
Tulipwood



Cupaniopsis anacardiodes
Tuckeroo



Carex appressa
Tall Sedge



Ficinia nodosa
Knobby Club Rush



Lomandra hystrix
A Mat-rush



Lomandra longifolia
Spiny-headed Mat-rush



Grevillea Poorinda
Royal mantle



Juncus usitatus
Common rush



Banksia robur
Swamp banksia



Melaleuca thymifolia
Thyme honey myrtle

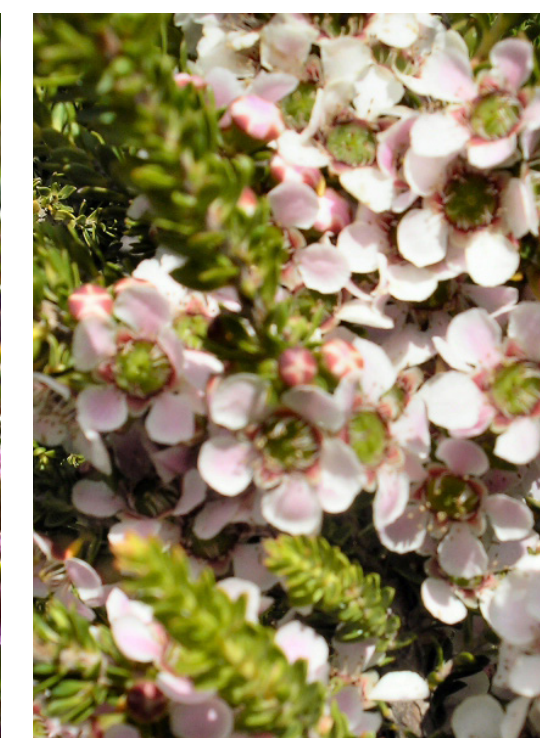

Leptospermum liversidgei
Olive tea-tree



Melaleuca seiberi
River bottlebrush

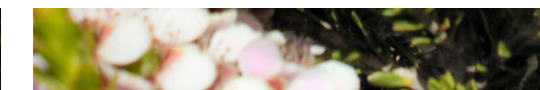
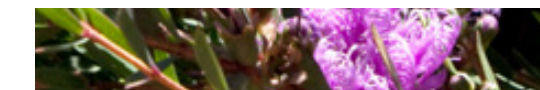
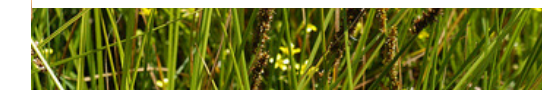

2.8 Hardstand Plan

Concept Design



Concept Design

2.8 Hardstand Plan

- S Standard Concrete Footpath**
Standard Grey Concrete footpath, potential to be an exposed aggregate or broom finish but with no colour additives.
- M Scarr Street Central Median**
Central median hardstand to potentially include a coloured concrete and/or exposed aggregate finish for delineation as a footpath network, directing traffic towards the pedestrian crossings rather than a kerb/vehicle stop.
- P Plaza Paving**
Feature paving/stonework/Streetbond/sandblasting treatment to the outdoor plaza area, final finish to tie into furniture and shade structures and enhance the area as a pedestrian zone. Potential to extend this treatment to include the central median.
- F Feature Hardstand**
Opportunities to include a feature coloured concrete treatment to points of interest along the outer footpaths including entrances to historical buildings, community precinct the Florance Clark memorial park etc.
- C Pedestrian Crossings**
Pedestrian crossings treated with approved red/pink coloured road marking paint, conforming to Australian standards.
- R Scarr St Pavement**
Scarr Street road design/finish and line markings to traffic and civil engineers specification.



Standard Grey Concrete
Footpath Finish



Exposed Aggregate
Footpath Finish



Coloured Concrete "Latte"
Median/Feature Coloured Concrete



Coloured Concrete "Spice"
Median/Feature Coloured Concrete



Coloured Concrete "Burnt Orange"
Median/Feature Coloured Concrete



Cobblestone
Plaza Feature Paving

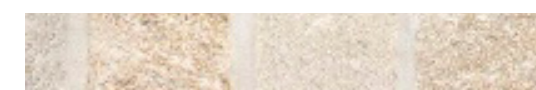

Concrete Sandblasting/Streetbond
Plaza Feature Treatment



Concrete Print "British Cobble"
Plaza Feature Paving

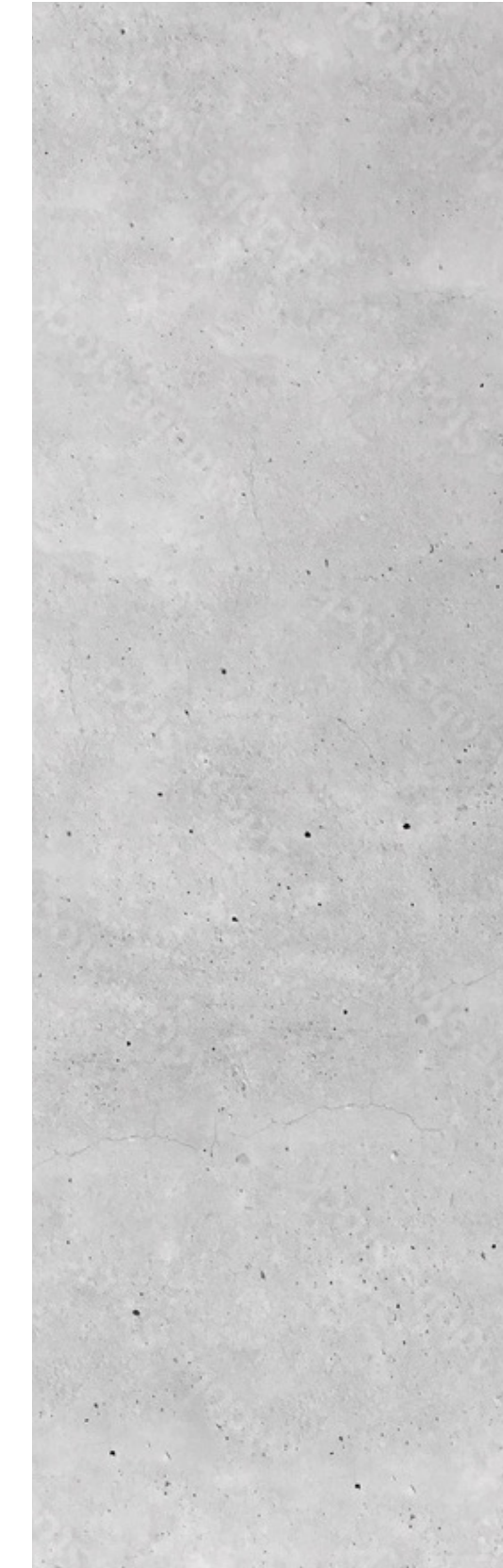

Formwork Concrete
Light Grey / Sandblasted Pattern Finish

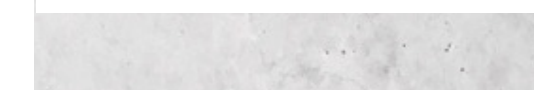

Pedestrian Crossings
Road Markings



2.10 Network & Wayfinding Strategy

Concept Design

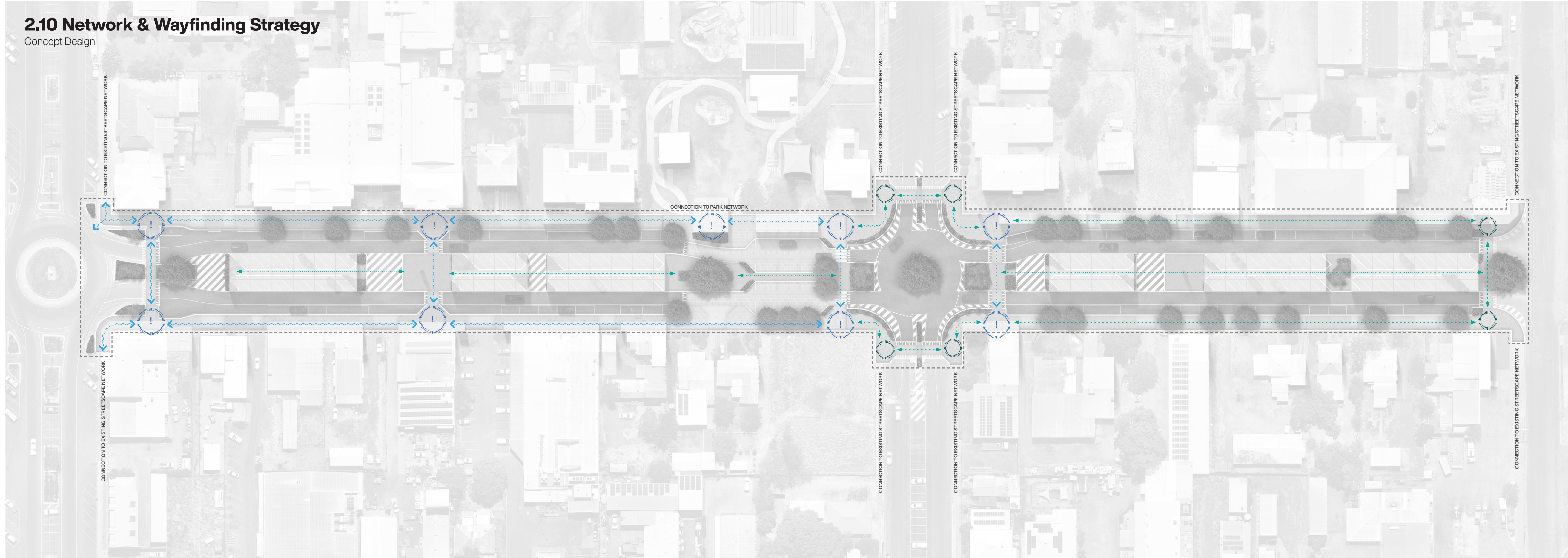

Concept Design

2.10 Network Plan & Wayfinding Strategy

Wayfinding Strategy





A wayfinding strategy provides an over-arching view of legibility and connection for a space. To ensure there is a coordinated approach, wayfinding must be developed as an integral part of the overall design strategy. The wayfinding strategy should address the complete journey throughout space, and informs the development of stimuli to implement the strategy. The strategy is the overall method, while the system is the exact application of that method.

Wayfinding System

Wayfinding systems have the combined impact of architecture, landscaping, lighting, art, signs, people, printed and digital information. Used together as a system these components can communicate information effectively, helping people make good decisions about how to get to and from their destination. A good wayfinding system minimises the amount of time, attention and energy people need to spend finding their way, or helping others find their way. A good wayfinding system should make movement through the facility highly intuitive. Good wayfinding systems do not rely on signs alone. A broad approach will reduce frustration, stress and the unpleasant sensation of being lost.

Pedestrian Network & Nodes

Key pedestrian networks demonstrate key directional/activation nodes throughout the space where the way-finding strategy will be most influential. These areas have been used to inform proposed locations for signage and embellishments.

-  Primary Pedestrian Network
-  Secondary Pedestrian Network
-  Primary Network Nodes/Change of Direction
-  Secondary Network Nodes/Change of Direction

2.11 Signage Plan

Concept Design

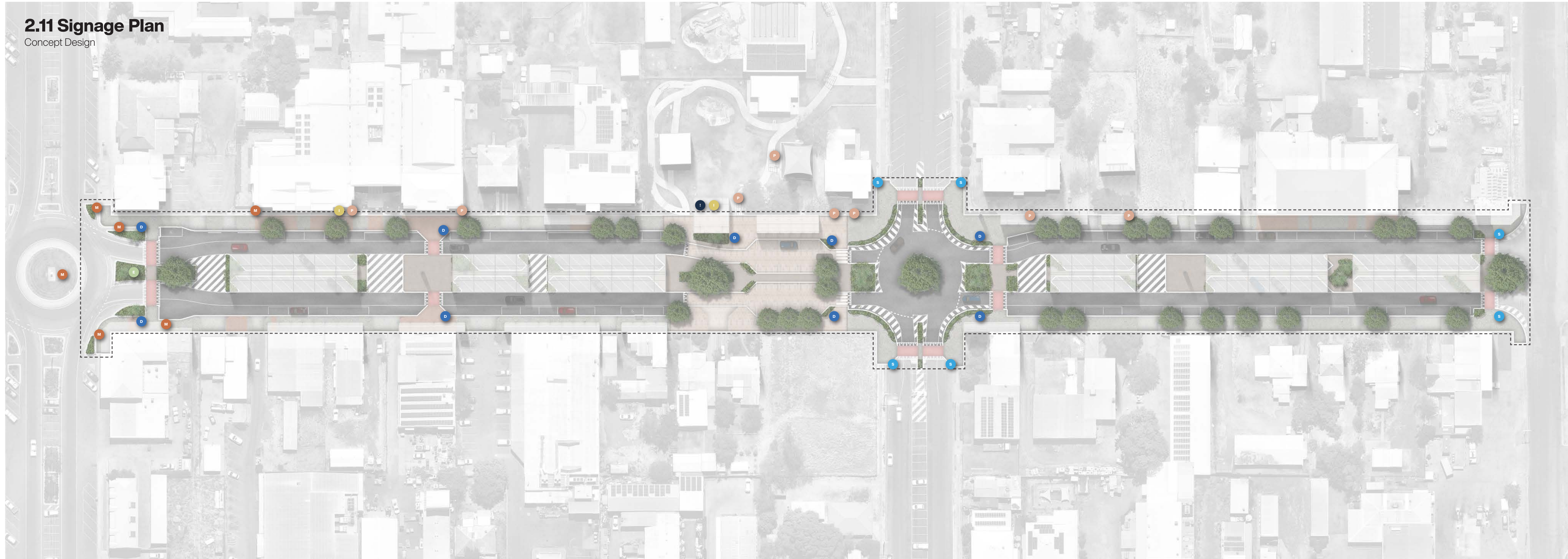

Concept Design

2.11 Signage Plan

- M Memorial Signage**
War memorial statues, signage & information boards. To be retained in their locations as part of the upgrade works and reinstalled where necessary.
- P Historical Information Plaques**
Cloncurry historical information plaques, mounted on metal plinth. To be retained in their locations as part of the upgrade works and reinstalled where necessary.
- I Information/Tourism Board**
Large information board within the plaza, showing directions and information regarding key points of interest within Cloncurry. Potential to include a historical walk route for the war memorials, information plaques and any public art installations within Scarr St.
- E Entry Statement**
Rustic style Scarr St entry statement, potentially including some public art installations or historically themed elements, planting to the base to frame. Inclusion of feature lighting to the base also an option.
- D Primary Pedestrian Directional Signage**
Primary directional signage to be incorporated as required. Potential to include a historical walk route for the war memorials, information plaques and any public art installations within Scarr St. Signage hierarchy and locations to be confirmed/completed under Wayfinding analysis.
- S Secondary Pedestrian Directional Signage**
Secondary directional signage to be incorporated as required. Potential to include a historical walk route for the war memorials, information plaques and any public art installations within Scarr St. Signage hierarchy and locations to be confirmed/completed under Wayfinding analysis.
- I Feature Digital Display Board**
Digital display board to be located within shelter.

2.12 Embellishments Plan

Concept Design

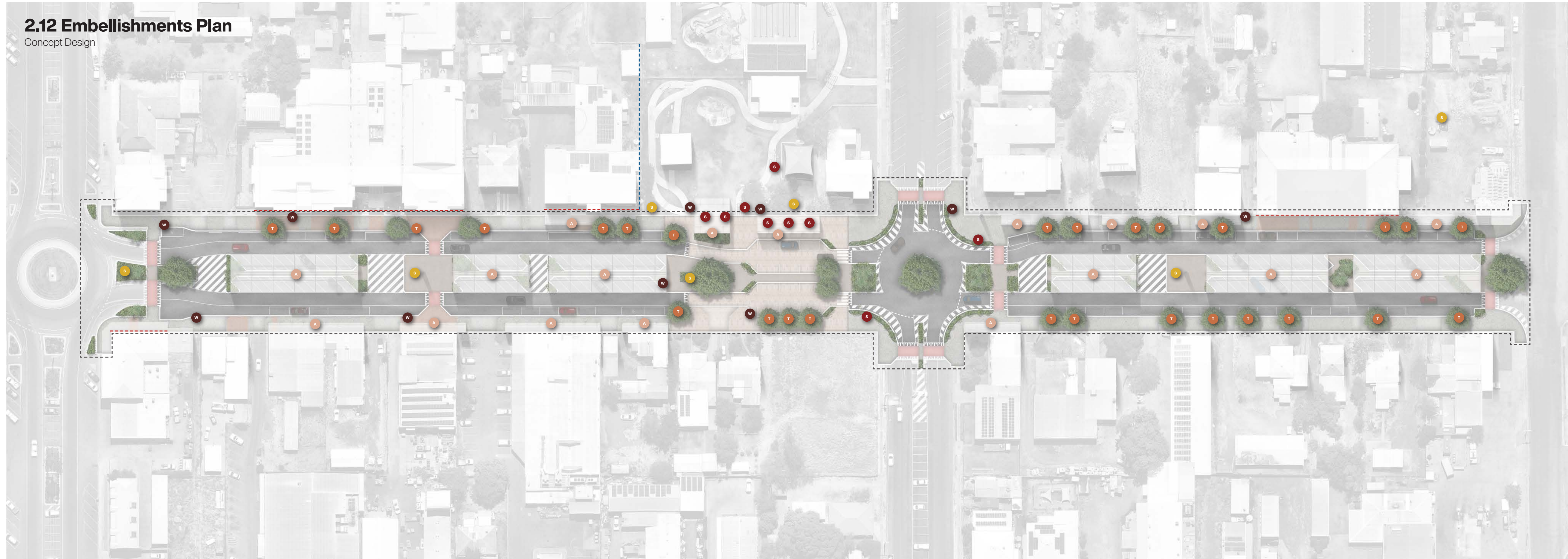

Concept Design

2.12 Embellishments Plan

- W** **Waste Bin Enclosures**
 Formal lockable bin enclosures for both landfill and recycling, with bird covers. Opportunity to use laser cut paneling design and powder coating of components to tie into colour themes of the streetscape and Cloncurry shire character.
- S** **Bench/Picnic Seating**
 Public bench seating and picnic tables. Colour finishes and design details to mimic bin enclosure palette as an embellishments suite to tie Scarr St together as a singular public space. Potential to use off form concrete plinths as informal seating.
- T** **Tree Grates**
 Metal tree protection grates. Rustic/Corten steel with laser cut design elements to tie into other proposed embellishments.
- A** **Awning/Shelters**
 Awnings and shelters as designed by structural engineer, cantilevered off existing buildings and center median to provide shaded parking and pedestrian footpath. Design and placement to be determined.
- S** **Sculptures**
 Potential sculpture artwork location throughout Scarr St, potential abstract animals created using agricultural equipment. Detail to be determined.
- Historical Frontages**
 Historical and character rich frontages of existing buildings, ideally avoiding built structures to the frontage and frame landscape/tree planting to maintain sight lines to building entrances & facade.
- Public Artwork/Mural**
 Artwork/Mural to fence interface within park. Details to be determined.

2.13 Embellishments

Concept Design



2.14 Signage/Sculptures

Concept Design

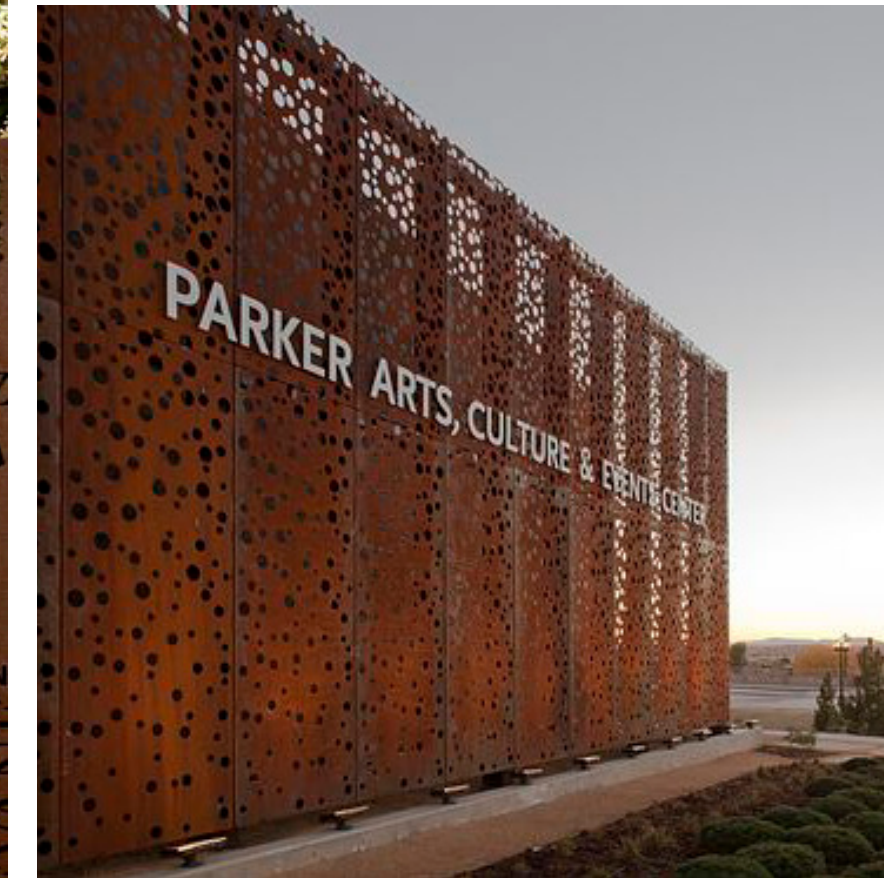

2.15 Embellishment Options

Concept Design



Concept Design

2.15 Embellishment Options

- 1 **Waste Bin Enclosures**
Formal lockable bin enclosures for both landfill and recycling, with bird covers. Opportunity to use laser cut paneling design and powder coating of components to tie into colour themes of the streetscape and Cloncurry shire character.
- 2 **Bench/Picnic Seating**
Public bench seating and picnic tables. Colour finishes and design details to mimic bin enclosure palette as an embellishments suite to tie Scarr St together as a singular public space. Potential to use off form concrete plinths as informal seating.
- 3 **Awning/Shelters**
Awnings and shelters as designed by structural engineer, cantilevered off existing buildings and center median to provide shaded parking and pedestrian footpath. Design and placement to be determined.
- 4 **Sculptures**
Potential sculpture artwork location throughout Scarr St, potential abstract animals created using agricultural equipment. Detail to be determined.
- 5 **Directional Signage**
Primary and secondary directional signage to be incorporated as required. Signage hierarchy to be confirmed. Potential to include a historical walk route for the war memorials, information plaques and any public art installations within Scarr St.
- 6 **Entry Statement**
Rustic style Scarr St entry statement, potentially including some public art installations or historically themed elements, planting to the base to frame. Potential to incorporate feature lighting to base.

2.16 Embellishment Options/Materials

Example Suite



Hyve Picnic
GrilleX

Cantilever Shelter
Example Only - Refer to Structural Plans for details

Reviva Drinking Fountain
GrilleX



Hyve Park Seat
GrilleX

Elite BBQ
GrilleX

Integra EX Bin Enclosure
GrilleX

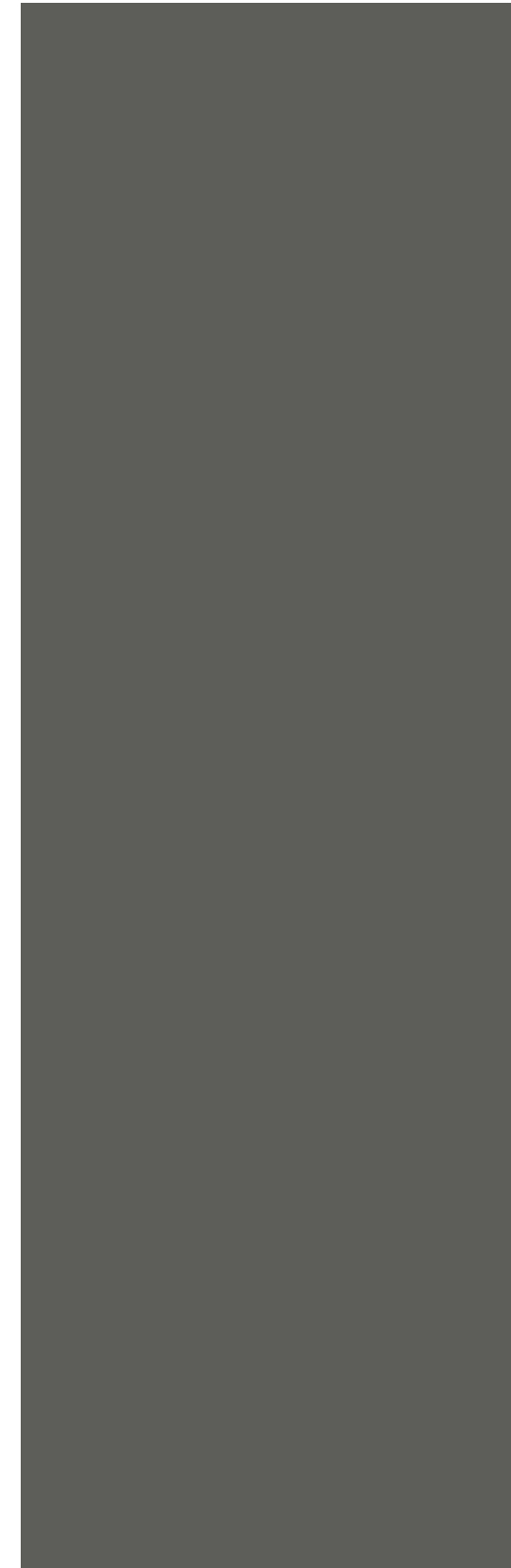
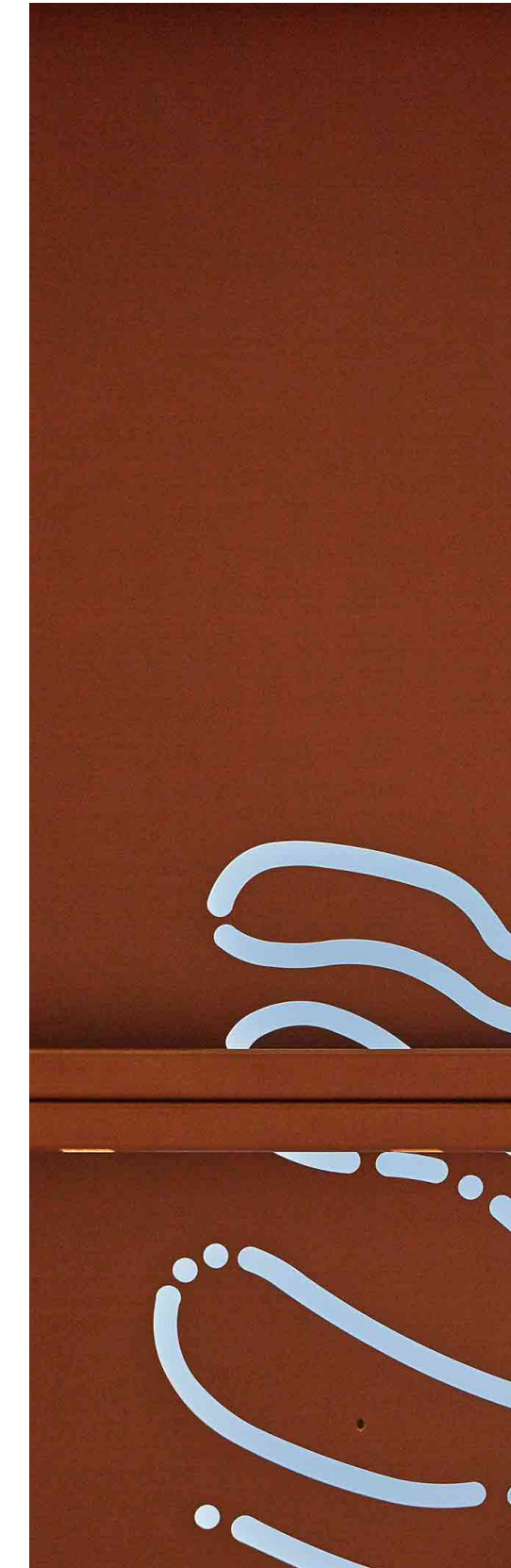

Corten Steel
Feature Laser Cut Panels

Powdercoat "Weathered Steel"
Powdercoat Texture Finish

Powdercoat "Woodland Grey"
Powdercoat Finish

Powdercoat "Territory Red"
Powdercoat Finish

Hardwood Timber
Powdercoat Finish Timber Wrap or Recycled Timber

2.17 Lighting Plan

Concept Design



Concept Design

2.17 Lighting Plan

- **Shelter Lighting**
 Shelter mounted lighting fixtures. Priorities shelter mounted lighting over pole mounted where feasible around central median awning and park adjacent shelters. Refer electrical plans for specifications.
- **Road Lighting (5m)**
 Lighting to the Scarr St Road Network including pedestrian crossings, 5m Poles. Refer electrical plans for design and specifications.
- **Road Lighting (8m)**
 Lighting to the Scarr St Road Network including pedestrian crossings, 8m Poles. Refer electrical plans for design and specifications.
- **Bollard Lighting**
 Pedestrian bollards with feature lighting elements. Design/detail to be determined.
- **Feature Lighting**
 Feature fairy lighting to existing park trees and feature up-lighting to artwork/sculptures/entry statement and feature trees.



Concurry
Shire Council



Prepared By Zone Landscape Architecture | www.zonelandscape.com.au